

Service Manual

ORDER NO.
RRV2348

STEREO CD TUNER

XC-NS1

THIS MANUAL IS APPLICABLE TO THE FOLLOWING MODEL(S) AND TYPE(S).

Type	Model XC-NS1	Power Requirement	Remarks
ZBDXJ	○	DC power supplied from other system component	
ZLXJ/NC	○	DC power supplied from other system component	
ZPWXJ	○	DC power supplied from other system component	

- This product is a system(s) component.
This product does not function properly independently ; to avoid malfunctions, be sure to connect it to the prescribed system component(s), otherwise damage may result.
- Please connect it to the STEREO POWER AMPLIFIER M-NS1 for adjustment and operation inspection.

Component	Model	Service manual	Remarks
STEREO CD TUNER	XC-NS1	RRV2348 (RRV2341)	This manual.
STEREO POWER AMPLIFIER	M-NS1	RRV2349 (RRV2321)	
SPEAKER SYSTEM	S-NS1-LRW	RRV2371	Except ZPWXJ type
MINIDISC RECORDER	MJ-NS1	RRV2363	

- This service manual should be used together with the following manual(s):

Model No.	Order No.	Remarks
XC-F10/ZUXJ/CA	RRV2341	

1. SAFETY INFORMATION

LITHIUM BATTERY NOTICE

WARNING!

Lithium batteries. Danger of explosion. Replacement must be done by qualified personnel and only by following the instructions given in the service manual.

This warning is stated on the product or in the operating instructions. When replacing the lithium batteries, follow the note below.

Dispose of the used battery promptly. Keep away from children. Do not disassemble and do not dispose of in fire.

The battery used in this device may present a fire or chemical hazard if mistreated. Do not recharge, disassemble, heat above 100°C or incinerate. Replace only with the same Part Number. Use of another battery may present a risk of fire or explosion.

Note: The lithium battery installation position is shown in the exploded views.

ADVARSEL!

Lithiumbatteri – Eksplosionsfare ved fejlagtig håndtering. Udskiftning må kun ske med batteri af samme fabrikat og type. Levér det brugte batteri tilbage til leverandøren.

Denne advarsel er angivet på produktet eller i brugsvejledningen. Ved udskiftning af lithium batterierne følges nedenstående anvisning.

Batterierne må kun udskiftes med batterier af samme type og mærke.

LABEL CHECK

CAUTION
INVISIBLE LASER
RADIATION WHEN OPEN,
AVOID EXPOSURE
TO BEAM PRW1018

Additional Laser Caution

1. Laser Interlock Mechanism
The position of the switch (S5907) for detecting loading state is detected by the system microprocessor, and the design prevents laser diode oscillation when the switch (S5907) is not on CLOSE terminal side (CDO/C signal is high level).
Thus, the interlock will no longer function if the switch (S5907) deliberately set to CLOSE terminal side (low level).
The interlock also does not function in the test mode*.
Laser diode oscillation will continue, if pin 9 of TA2150FN (IC1101) on the SELF-CHACK CD ASSY is connected to GND, or pin 10 is connected to low level (ON), or else the terminals of Q1101 are shorted to each other (fault condition).
2. When the DOOR WINDOW is removed, close viewing of the objective lens with the naked eye will cause exposure to a Class 1 laser beam.

* : Refer to page 29 on the service manual RRV2341.

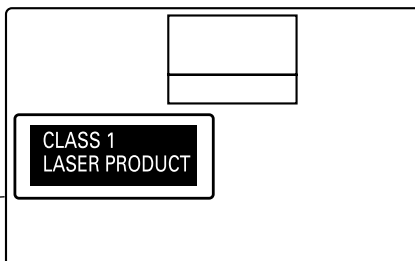
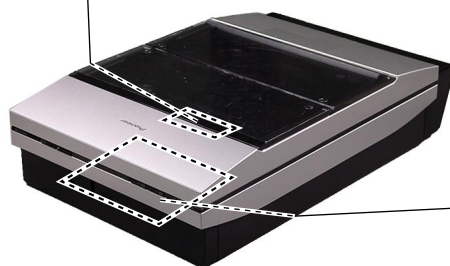

IMPORTANT

THIS PIONEER APPARATUS CONTAINS LASER OF CLASS 1. SERVICING OPERATION OF THE APPARATUS SHOULD BE DONE BY A SPECIALLY INSTRUCTED PERSON.

LASER DIODE CHARACTERISTICS

MAXIMUM OUTPUT POWER: 5 mW
WAVELENGTH: 780 – 785 nm

2. CONTRAST OF MISCELLANEOUS PARTS

NOTES: ●Parts marked by "NSP" are generally unavailable because they are not in our Master Spare Parts List.

●The Δ mark found on some component parts indicates the importance of the safety factor of the part.

Therefore, when replacing, be sure to use parts of identical designation.

●Screws adjacent to ∇ mark on product are used for disassembly.

●Reference Nos. indicate the pages and Nos. in the service manual for the base model.

●When ordering resistors, first convert resistance values into code form as shown in the following examples.

Ex.1 When there are 2 effective digits (any digit apart from 0), such as 560 ohm and 47k ohm (tolerance is shown by J=5%, and K=10%).

560 \rightarrow $56 \times 10^1 \rightarrow$ 561 RD1/4PU $\boxed{5}\boxed{6}\boxed{1}J$

47k \rightarrow $47 \times 10^3 \rightarrow$ 473 RD1/4PU $\boxed{4}\boxed{7}\boxed{3}J$

0.5 \rightarrow R50 RN2H $\boxed{R}\boxed{5}\boxed{0}K$

1 \rightarrow 1R0 RS1P $\boxed{1}\boxed{R}\boxed{0}K$

Ex.2 When there are 3 effective digits (such as in high precision metal film resistors).

5.62k \rightarrow $562 \times 10^1 \rightarrow$ 5621 RN1/4PC $\boxed{5}\boxed{6}\boxed{2}\boxed{1}F$

■ CONTRAST TABLE

XC-NS1/ZBDXJ, ZLXJ/NC, ZPWXJ and XC-F10/ZUXJ/CA are constructed the same except for the following :

Ref. No.	Mark	Symbol and Description	Part No.				Remarks
			XC-F10 /ZUXJ/CA	XC-NS1 /ZBDXJ	XC-NS1 /ZLXJ/NC	XC-NS1 /ZPWXJ	
P5- 1	NSP	PCB ASSEMBLIES					
		CD TX MAIN ASSY └ MAIN UNIT	AWM7528 AWU7621	AWM7529 AWU7622	AWM7529 AWU7622	AWM7529 AWU7622	
P3- 3 P3- 5	Δ	PACKING SECTION					
		Packing Case	AHD7916	AHD7917	AHD7918	AHD7919	
		Stand Note	ARM7044	Not used	Not used	ARM7044	
		Paper Pattern	Not used	AAX7807	AAX7807	Not used	No. 1
		System Cable (20P)	Not used	ADE7057	ADE7057	Not used	No. 2
		Power Cord	Not used	ADG1158	ADG1154	Not used	No. 3
		FM Wire Antenna	Not used	ADH7004	ADH7004	Not used	No. 4
		Spacer	Not used	AHB7038	AHB7038	Not used	No. 5
		Spacer CD/VCD	Not used	AHB7040	AHB7040	Not used	No. 6
		Operating Instructions (English/Chinese/Spanish)	Not used	ARE7265	ARE7265	Not used	No. 7
		Loop Antenna	Not used	ATB7009	ATB7009	Not used	No. 8
		Ferrite Core	Not used	ATX7007	ATX7007	Not used	No. 9
		Remote control Unit	Not used	AXD7271	AXD7271	Not used	No. 10
		Battery Lid	Not used	AZN7834	AZN7834	Not used	No. 11
		Stand A	Not used	AXG7096	AXG7096	Not used	No. 12
		Stand B	Not used	AXG7097	AXG7097	Not used	No. 13
P5-63 P5-65 P5-66	NSP Δ	Lithium Battery (CR2025)	Not used	VEM1009	VEM1009	Not used	No. 14
	NSP	Polyethylene Bag (115 × 270 × 0.05)	Not used	Z21-013	Z21-013	Not used	No. 15
	NSP	Polyethylene Bag (0.03 × 230 × 340)	Not used	Z21-038	Z21-038	Not used	No. 16
	NSP	EXTERIOR SECTION					
P5-63 P5-65 P5-66	NSP	Name Label	AAL7259	AAL7260	AAL7261	AAL7262	
		65 Label	ARW7050	Not used	Not used	Not used	
		Label M	ARW7108	ARW7108	Not used	Not used	
		Caution Label	Not used	PRW1018	PRW1018	PRW1018	*1

Notes : The numbers in the remarks column correspond to the numbers on the "EXPLODED VIEWS".

For PCB ASSEMBLIES, Refer to "CONTRAST OF PCB ASSEMBLIES".

*1 Refer to "LABEL CHECK".

EXPLODED VIEWS

PACKING SECTION (Except ZPWXJ type)

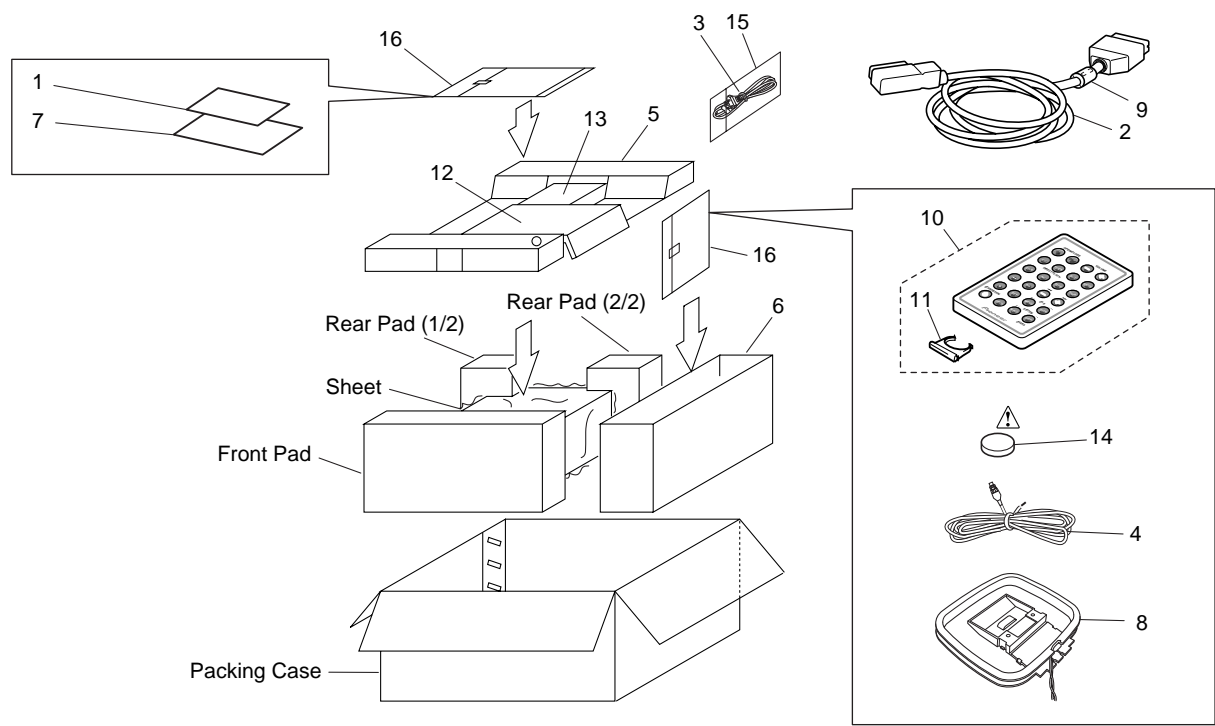

CONTRAST OF PCB ASSEMBLIES

CF MAIN UNIT

AWU7622 and AWU7621 are constructed the same except for the following :

Mark	Symbol and Description	Part No.		Remarks
		AWU7621	AWU7622	
R5575		RS1/16S223J	RS1/16S103J	
R5577		RS1/16S333J	RS1/16S393J	