

# Service Manual

ORDER NO.  
RRV2961

DVD/CD RECEIVER

# XV-DV8

THIS MANUAL IS APPLICABLE TO THE FOLLOWING MODEL(S) AND TYPE(S).

Model	Type	Power Requirement	Region No.	Remarks
XV-DV8	LFXJ	AC110- 120V	3	-

- This service manual should be used together with the following manual(s).

Model No.	Order No.	Remarks
XV-DV8/DLXJ/NC	RRV2908	

# 1. CONTRAST OF MISCELLANEOUS PARTS

- NOTES:
- Parts marked by "NSP" are generally unavailable because they are not in our Master Spare Parts List.
  - The  $\triangle$  mark found on some component parts indicates the importance of the safety factor of the part. Therefore, when replacing, be sure to use parts of identical designation.
  - Screws adjacent to  $\nabla$  mark on product are used for disassembly.
  - For the applying amount of lubricants or glue, follow the instructions in this manual. (In the case of no amount instructions, apply as you think it appropriate.)
  - Reference Nos. indicate the pages and Nos. in the service manual for the base model.

## ■ CONTRAST OF TABLE

XV-DV8/LFXJ and /DLXJ/NC are constructed the same except for the following:

Ref. No.	Mark	Symbol and Description	Part No.		Remarks
			XV-DV8 /DLXJ/NC	XV-DV8 /LFXJ	
P9- 7	NSP	<PCB ASSEMBLIES> COMPLEX ASSY PRIMARY ASSY	XWM3237 XWZ3845	XWM3238 XWZ3859	No. 1
P7- 1 P7-15	$\triangle$	<PACKING> AC Power Cord Packing Case (English/Trad-Chinese)	ADG1154 XHD3424	ADG7098 XHD3420	
P9-14 P9-15	$\triangle$ $\triangle$	<EXTERIOR SECTION> Power Transformer(T1) Fuse (FU 1)	ATS7355 REK1029 (5.0A/250V)	ATS7354 REK1069 (6.3A/125V)	
P9-22 P9-45		Rear Panel (MTL) Caution Label Region Label	XNC3275 VRW1872 Not used	XNC3278 VRW1961 VRW1702	
P11- 7		<FRONT PANEL SECTION> Display Window	XAK3447	XAK3447	

- Notes :
- The numbers in the remarks column correspond to the numbers on the "EXPLODED VIEWS".
  - For PCB ASSEMBLIES, Refer to "CONTRAST OF PCB ASSEMBLIES" and "2. SCHEMATIC DIAGRAM".

EXPLODED VIEWS

EXTERIOR SECTIONS

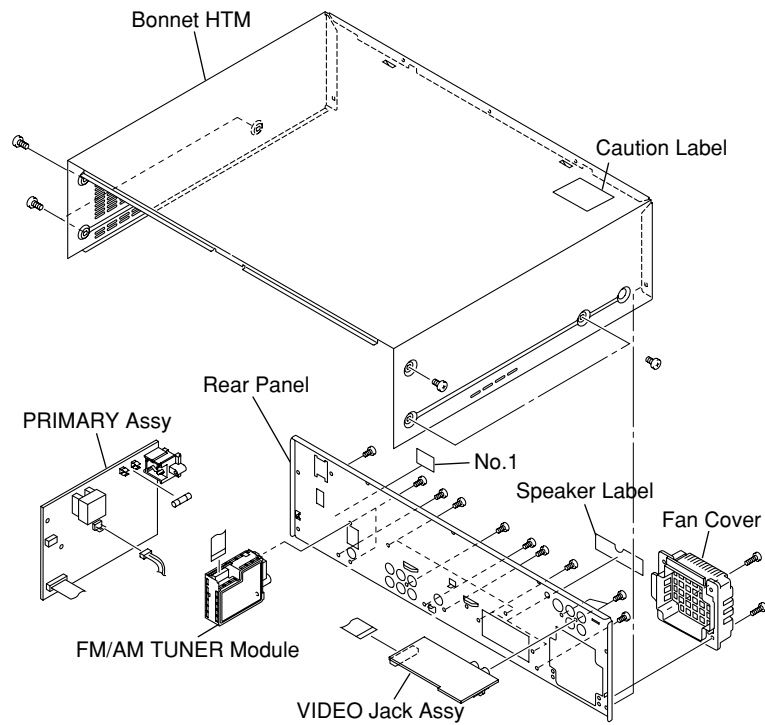

CONTRAST OF PCB ASSEMBLIES

**KF** PRIMARY ASSY

XWZ3859 and XWZ3845 are constructed the same except for the following :

Mark	Symbol and Description	Part No.		Remarks
		XWZ3845	XWZ3859	
	T002 Stand by Transformer (T 2) AN01 1P AC INLET CN 02 5P-VH Connector S0101,S0102 Voltage Selector	ATT7080 XKP3041 B5P9-VH AKX7017	ATT7079 XKP3042 Not used Not used	

# 2. SCHEMATIC DIAGRAM

## 2.1 PRIMARY and VIDEO JACK ASSYS

A

B

C

D

E

F

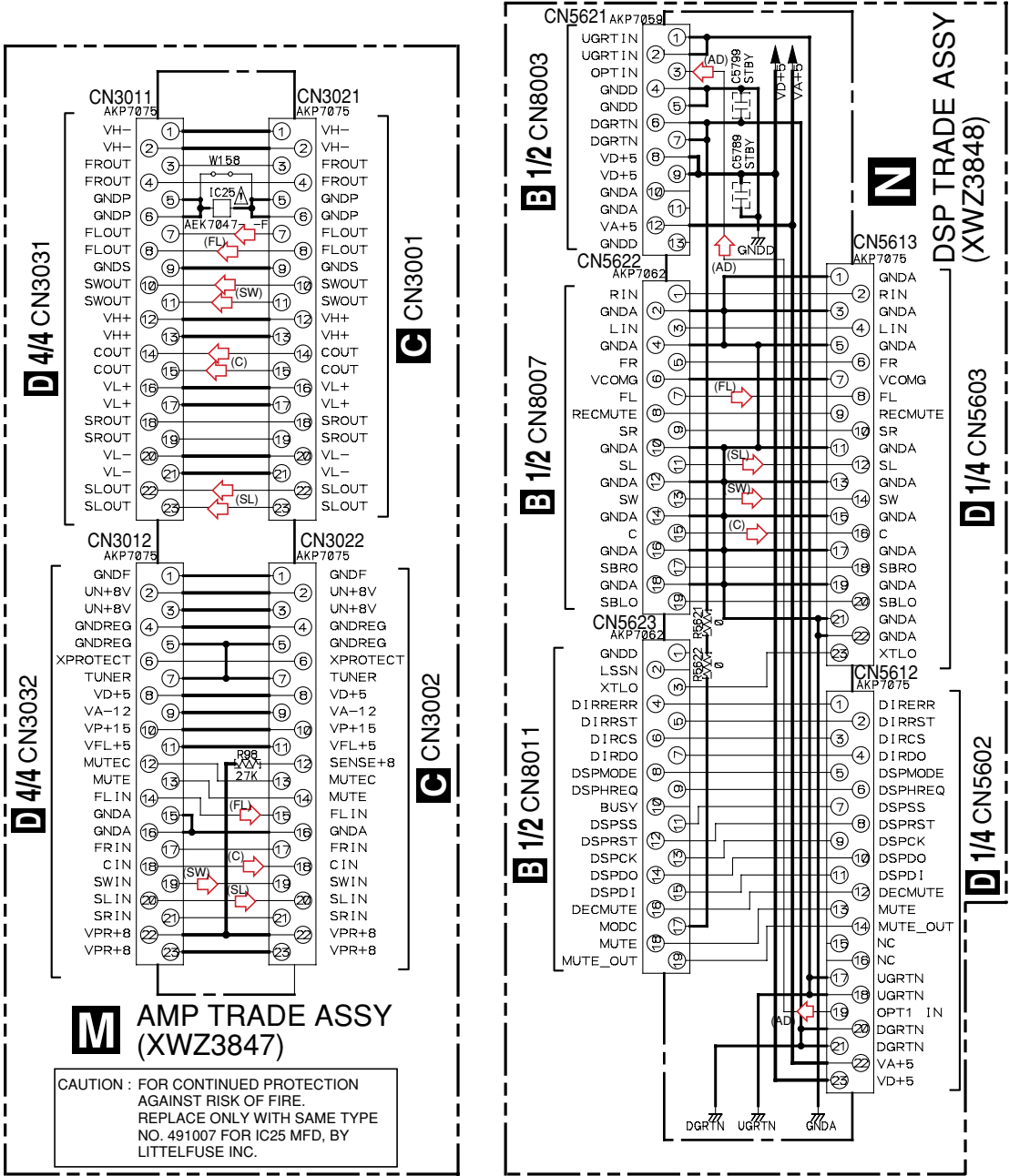

### NOTES

ALL CAPACITORS ARE IN  $\mu$ F  
UNLESS OTHERWISE SPECIFIED

CKSRYB

CEJQ\*\*\*M##  
UQ

CAUTION  
FOR CONTINUED PROTECTION  
AGAINST RISK OF FIRE,  
REPLACE WITH SAME TYPE  
AND RATINGS OF FUSE.

NO MARK DIODE

1S5133

CEAT\*\*\*M##

AC POWER CORD  
LIVE  
NEUTRAL  
ADG7098  
XKP3042

- (AD) : AUDIO DATA SIGNAL ROUTE
- (FL) : AUDIO SIGNAL ROUTE (Front L ch)
- (SL) : AUDIO SIGNAL ROUTE (Surround L ch)
- (C) : AUDIO SIGNAL ROUTE (Center ch)
- (SW) : AUDIO SIGNAL ROUTE (Sub Woofer ch)

NOTE FOR FUSE REPLACEMENT

CAUTION -FOR CONTINUED PROTECTION AGAINST RISK OF FIRE,  
REPLACE WITH SAME TYPE AND RATINGS OF FUSE.

K F M N

K F PRIMARY ASSY  
(XWZ3859)

KN1  
VNF1084  
CHASSIS GND

